

# CITY AND COUNTY OF SWANSEA

## ENFORCEMENT NOTICE - OPERATIONAL DEVELOPMENT

*IMPORTANT - THIS COMMUNICATION AFFECTS YOUR PROPERTY*

### TOWN AND COUNTRY PLANNING ACT 1990 (AS AMENDED BY THE PLANNING AND COMPENSATION ACT 1991)

#### ENFORCEMENT NOTICE

**ISSUED BY: THE COUNCIL OF THE CITY AND COUNTY OF  
SWANSEA ("THE COUNCIL")**

1 **THIS NOTICE** is issued by the Council because it appears to them that there has been a breach of planning control within paragraph (a) of section 171A(1) of the above Act, at the land described below. They consider that it is expedient to issue this notice, having regard to the provisions of the development plan and to other material planning considerations. The Annex at the end of this notice and the enclosures to which it refers contain important additional information.

2 **THE LAND TO WHICH THE NOTICE RELATES**

Land at **Brookdale, Llanrhidian, Swansea** shown edged red on the attached plan

3 **THE MATTERS WHICH APPEAR TO CONSTITUTE THE BREACH OF PLANNING CONTROL**

Without planning permission, the erection of an outbuilding

4 **REASONS FOR ISSUING THIS NOTICE**

It appears to the Council that the above breach of planning control has occurred within the last four years.

The development by virtue of its size, design and siting results in the introduction of a visually obtrusive structure which is detrimental to the natural beauty of this part of the Gower AONB. It is considered that there is no acceptable justification for the development and as such is considered contrary to Unitary Development Plan Policy EV26 which seeks to conserve and enhance the natural beauty of the AONB.

## 5 WHAT YOU ARE REQUIRED TO DO

Demolish the outbuilding and remove all resulting materials from site.

## 6 TIME FOR COMPLIANCE

6 months from the date on which this notice takes effect.

## 7 WHEN THIS NOTICE TAKES EFFECT

This notice takes effect on 23<sup>rd</sup> December 2010 unless an appeal is made against it beforehand.

Date **23<sup>rd</sup> November 2010**

Signed



*Designation :Acting Head of Legal &  
Democratic Services  
(The Council's authorised officer)*

Address to which all communication should be sent:

*Phil Holmes, Head of Economic Regeneration and Planning  
Civic Centre, SWANSEA. SA3 4SN*

---

## ANNEX

### YOUR RIGHT OF APPEAL

You can appeal against this notice, but any appeal must be **received**, or posted in time to be received, by the Planning Inspectorate appointed by the National Assembly for Wales **before** the date specified in paragraph 7 of the notice. The enclosed booklet "Enforcement Appeals - A Guide to Procedure" sets out your rights. You may use the enclosed appeal forms:

- [a] One is for you to send to the Planning Inspectorate if you decide to appeal together with a copy of this notice;
- [b] The second copy of the appeal form and the notice should be sent to the Council; and
- [c] The third copy is for your own records.

### WHAT HAPPENS IF YOU DO NOT APPEAL

If you do not appeal against this enforcement notice, it will take effect on the date specified in paragraph 7 of the notice and you must then ensure that the required steps for complying with it, for which you may be held responsible, are taken within the period(s) specified in paragraph 6 of the notice. Failure to comply with an enforcement notice which has taken effect can result in prosecution and/or remedial action by the Council.



# Brookdale, Llanrhidian

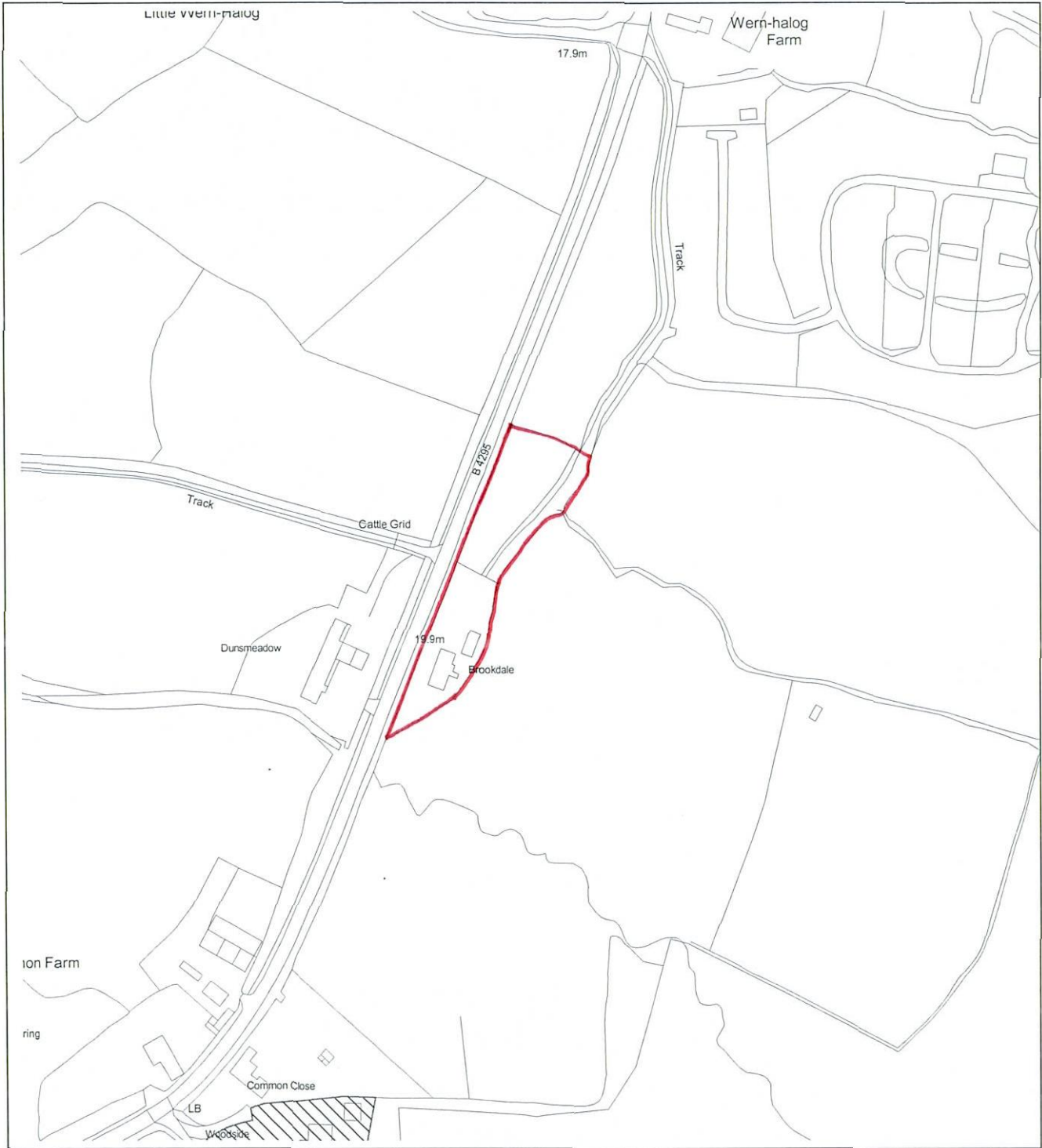

This material has been reproduced from Ordnance Survey digital map data with the permission of the controller of Her Majesty's Stationery Office, © Crown Copyright.

